



Carisbrook Terrace, Chiseldon, SN4 0LW

Guide Price £220,000

richard james

Village & Country Homes

richard
james



Carisbrook Terrace

Chiseldon

Freehold | EPC Rating - C



Nestled in the heart of Chiseldon, this delightful two-bedroom terrace offers a perfect blend of character and functionality.

Set within a quiet terrace, the property provides an ideal choice for first-time buyers, downsizers, or those seeking a welcoming home in a convenient location.

With a cozy rear garden, it offers an inviting outdoor space, perfect for enjoying a morning coffee or unwinding in the evenings. Inside, the home features a spacious sitting room, practical kitchen, and well-sized bathroom, delivering everything you need in an efficient layout.

The property is move-in ready, with the potential for personal touches to make it uniquely yours.



Chiseldon itself is known for its village charm and community spirit, with easy access to nearby Swindon for more extensive amenities, shopping, and transport links. Locally, residents enjoy the Three Trees cafe and beautiful countryside walks. Excellent commuter links via the M4 and nearby railway options make it an attractive base for city connections while enjoying the serene pace of village life.

EPC - C
Council Tax Band - B





richard
james

Floorplan

Approximate Area = 679 sq ft / 63 sq m

For identification only - Not to scale

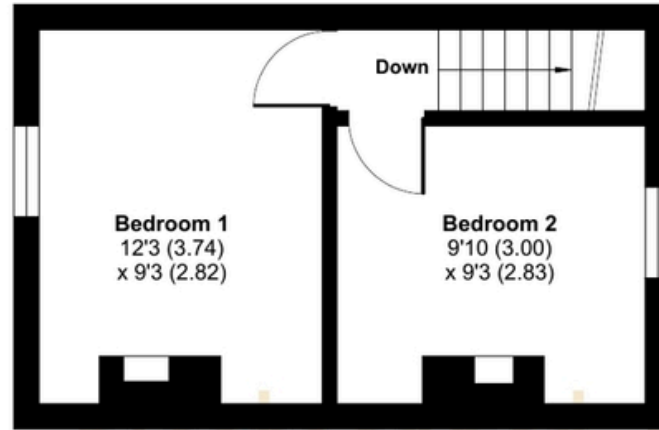

FIRST FLOOR

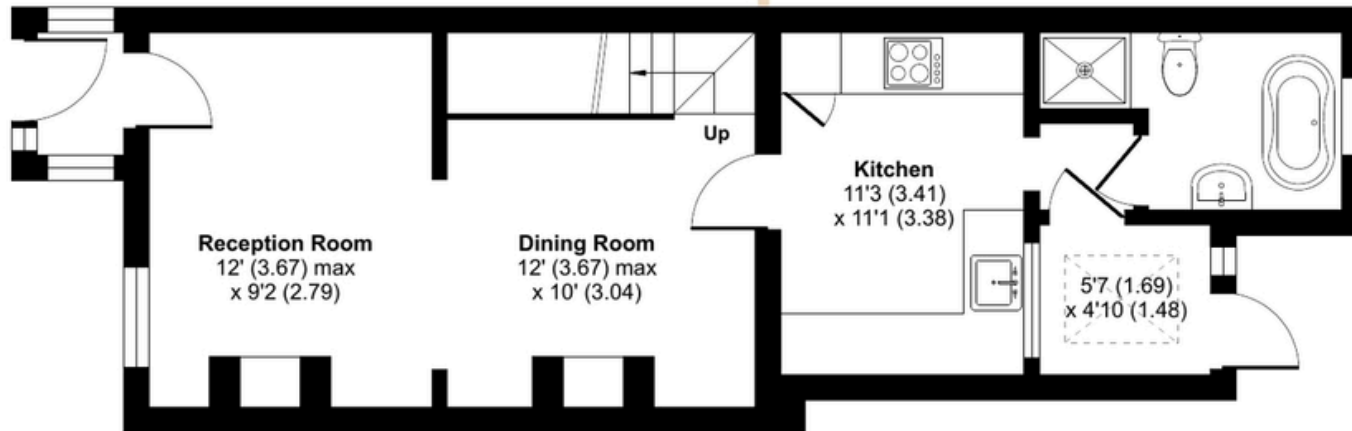

GROUND FLOOR



Floor plan produced in accordance with RICS Property Measurement 2nd Edition, Incorporating International Property Measurement Standards (IPMS2 Residential). © ritchecom 2024. Produced for Richard James Estate Agents Ltd. REF: 1202139

01793 814 542

wroughton@richardjames.uk

80 High Street | Wroughton | SN4 9JZ

richard james

richardjames.uk