



Glenwood Close, Old Town, SN1 4EB

asking price **£250,000**

**richard  
james**



freehold energy  
efficiency rating

T

- NO ONWARD CHAIN
- TWO DOUBLE BEDROOMS
- IN NEED OF RENOVATION
- EXTENSION OPPORTUNITY (STPP)
- QUIET LOCATION
- PRIVATE REAR GARDEN
- GARAGE TO THE REAR

This property offers a fantastic opportunity to renovate and extend (STPP) into the perfect bungalow whilst being offered to market with no onward chain. The property can be found in a quiet area on the edge of Old Town a





## exceptional service

Our team will guide you through the process of buying or selling your home. We have a team of dedicated sales progressors in place to ensure your purchase or sale runs smoothly through to completion, keeping you in the loop and a close eye on your chain while moving you in as swiftly and smoothly as possible.

- Honest valuations in current market conditions
- Dedicated sales progression team
- Recommended financial advisors
- 5\* service from valuation to completion
- Award winning lettings service
- Ahead of the game marketing strategies
- Professional photography
- Social media marketing
- Top listings on Rightmove and Zoopla

**call us for a free valuation on your property**

**[oldtown@richardjames.uk](mailto:oldtown@richardjames.uk)**

Victoria Road | Old Town | SN1 3BD

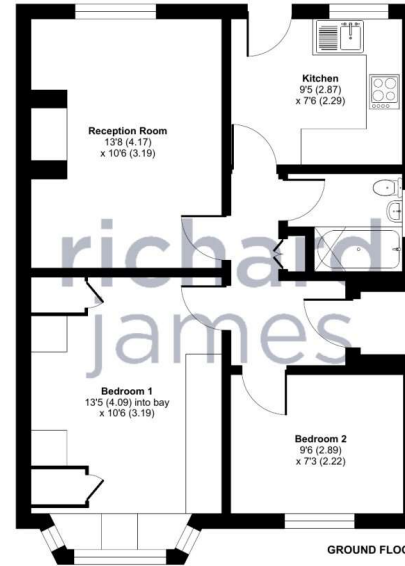

Floor plan produced in accordance with RICS Property Measurement Standards incorporating International Property Measurement Standards (IPMS2 Residential). © richjames 2024. Produced for Richard James. REF: 1194344

Approximate area = 0.02 sq ft / 0.12 sq m  
For identification only - Not to scale

**richard james**

### Richard James & their clients give notice that:

1. These sales and particulars do not constitute any part of an offer of contract, and are for the guidance of prospective purchasers only and should not be relied on as statements of fact.
2. No representations are made in these particulars as to the condition of the property or as to whether any service or facilities are in good working order.
3. All Measurements are approximate.

**rightmove**