



Tattershall, Toothill, SN5 8BX

guide price **£365,000 - £375,000**

**richard
james**



freehold energy
efficiency rating

D

This four bedroom detached home is well located in Toothill West Swindon and would be perfect for a family due to its good living space, its four generous bedrooms plus its large landscaped rear garden.

The ground floor living accommodation comprises; Entrance porch, entrance hall, W.C, a generous living room, the dining room, kitchen, a further reception room, a large integral garage plus conservatory.

The first floor offers; first floor landing, a generous main bedroom, bedroom two, a bay fronted third bedroom, bedroom four and the family bathroom.

To the rear is a large rear garden with a patio and a large lawn leading to a landscaped patio and pergola seating area.

To the front the property offers a generous driveway with parking for multiple vehicles.



exceptional service

Our team will guide you through the process of buying or selling your home.

We have a team of dedicated sales progressors in place to ensure your purchase or sale runs smoothly through to completion, keeping you in the loop and a close eye on your chain while moving you in as swiftly and smoothly as possible.

- Honest valuations in current market conditions
- Dedicated sales progression team
- Recommended financial advisors
- 5* service from valuation to completion
- Award winning lettings service
- Ahead of the game marketing strategies
- Professional photography
- Social media marketing
- Top listings on Rightmove and Zoopla

call us for a free
valuation on your
property

westswindon@richardjames.uk

Lucena House | Shaw Village Centre | SN5 5PY

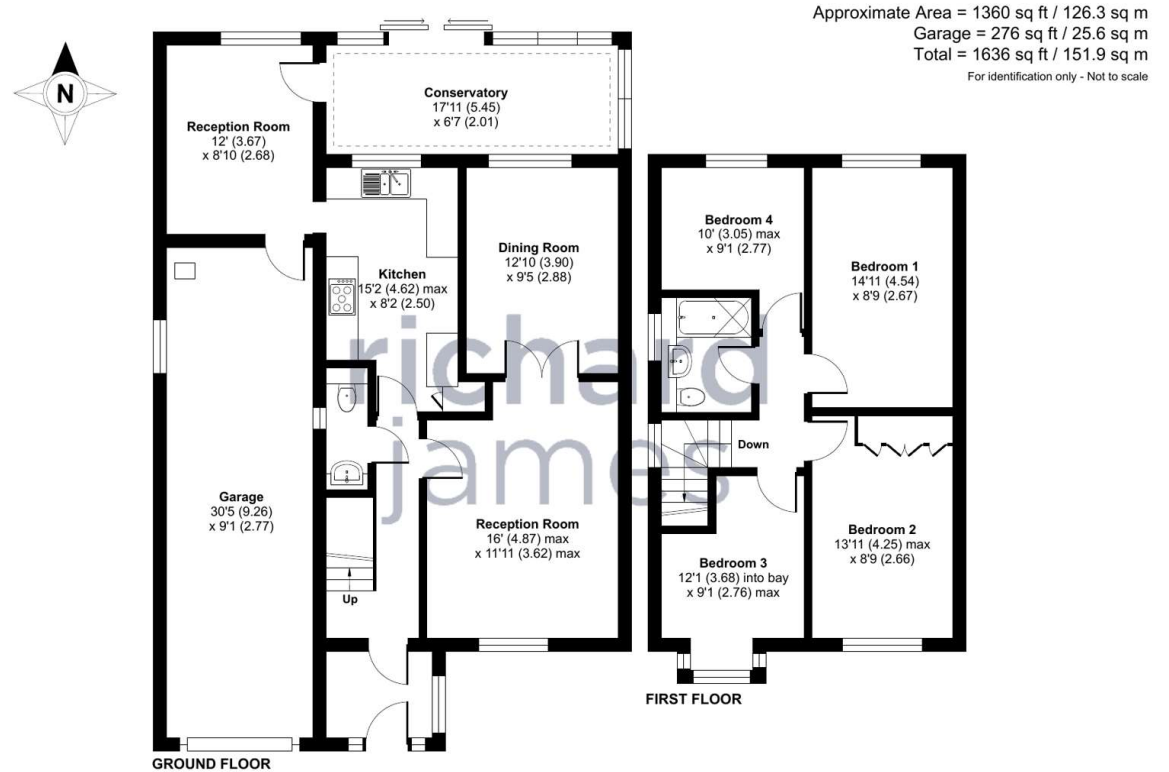

Floor plan produced in accordance with RICS Property Measurement Standards incorporating International Property Measurement Standards (IPMS2 Residential). © richcom 2024. Produced for Richard James. REF: 1193701

Richard James & their clients give notice that:

1. These sales and particulars do not constitute any part of an offer of contract, and are for the guidance of prospective purchasers only and should not be relied on as statements of fact.
2. No representations are made in these particulars as to the condition of the property or as to whether any service or facilities are in good working order.
3. All Measurements are approximate.

rightmove