



Beamans Park, Royal Wootton Bassett, SN4 7BX

Guide Price **£110,000**

**richard
james**



🛏️ 2 🛋️ 1 🚿 1

* energy efficiency rating

| T

** NO CHAIN **

A beautifully kept park home on a small development of similar properties. SHOPS AND AMMENTITIES are within easy walking distance.

There is a lovely feeling of NATURAL LIGHT AND SPACE. there are TWO BEDROOMS, a shower room, a decent living room with space for a DINING TABLE and also a modern kitchen.

It's ready to move into, you can decorate if needed as you see fit and you even have a garden to enjoy the sun in!

A happy retirement starts here at a fantastic price.

WELCOME HOME!....







richard
james



richard
james



Approximate Area = 471 sq ft / 43.7 sq m
For identification only - Not to scale

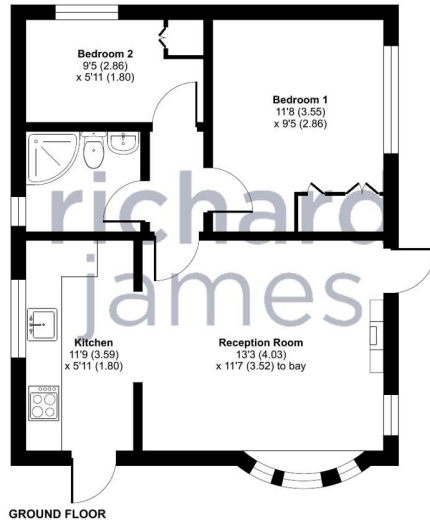

Floor plan produced in accordance with RICS Property Measurement Standards incorporating International Property Measurement Standards (IPMS2 Residential). ©richcom 2024. Produced for Richard James. REF: 1174245

call us for a free
valuation on your property

rwb@richardjames.uk

High Street | Royal Wootton Bassett | SN4 7AY

exceptional service

Our team will guide you through the process of buying or selling your home.

We have a team of dedicated sales progressors in place to ensure your purchase or sale runs smoothly through to completion, keeping you in the loop and a close eye on your chain while moving you in as swiftly and smoothly as possible.

- Honest valuations in current market conditions
- Dedicated sales progression team
- Recommended financial advisors
- 5* service from valuation to completion
- Award winning lettings service
- Ahead of the game marketing strategies
- Professional photography
- Social media marketing
- Top listings on Rightmove and Zoopla

call us for a free
valuation on your property

rwb@richardjames.uk

High Street | Royal Wootton Bassett | SN4 7AY

Richard James & their clients give notice that:

1. These sales and particulars do not constitute any part of an offer of contract, and are for the guidance of prospective purchasers only and should not be relied on as statements of fact.
2. No representations are made in these particulars as to the condition of the property or as to whether any service or facilities are in good working order.
3. All Measurements are approximate.

rightmove 