



Dover Street, Old Town, SN1 3JP

guide price **£200,000-£210,000**

**richard
james**



Freehold energy efficiency rating

A traditional red brick, terraced home, ideally situated in the heart of Old Town. Just a short walk from the many amenities on offer locally, and also conveniently located for access into the Town Centre and main Railway Station.

The accommodation includes Storm Porch, Hall, Two Reception Rooms, fitted Kitchen and Bathroom, with white suite. With the Two double Bedrooms, to the first floor.

Further features include an enclosed low maintenance garden to the rear with a pleasant Westerly facing aspect, PVCu Double Glazing and Gas Radiator Heating.

Viewing recommended by the vendors Sole Agents, Richard James.

Council Tax Band: B



exceptional service

Our team will guide you through the process of buying or selling your home.

We have a team of dedicated sales progressors in place to ensure your purchase or sale runs smoothly through to completion, keeping you in the loop and a close eye on your chain while moving you in as swiftly and smoothly as possible.

- Honest valuations in current market conditions
- Dedicated sales progression team
- Recommended financial advisors
- 5* service from valuation to completion
- Award winning lettings service
- Ahead of the game marketing strategies
- Professional photography
- Social media marketing
- Top listings on Rightmove and Zoopla

call us for a free
valuation on your
property

oldtown@richardjames.uk

Victoria Road | Old Town | SN1 3BD

Ground Floor

Approx. 42.3 sq. metres (455.7 sq. feet)

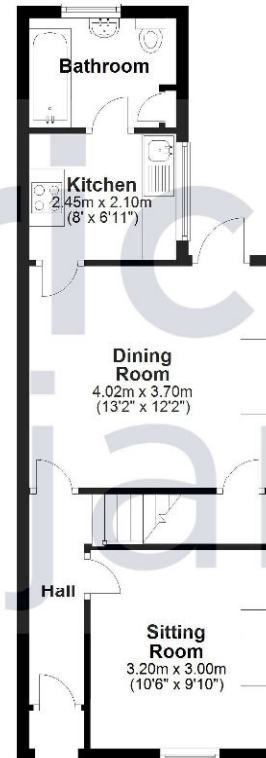

First Floor

Approx. 32.6 sq. metres (351.1 sq. feet)

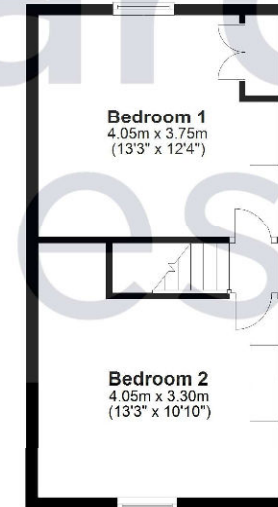

Total area: approx. 75.0 sq. metres (806.8 sq. feet)

Richard James & their clients give notice that:

1. These sales and particulars do not constitute any part of an offer of contract, and are for the guidance of prospective purchasers only and should not be relied on as statements of fact.
2. No representations are made in these particulars as to the condition of the property or as to whether any service or facilities are in good working order.
3. All Measurements are approximate.

rightmove 