



16 Ansun Drive, Watchfield  
**Offers Over £400,000**

**richard james**

Village & Country Homes



## Ansun Drive

Watchfield

Freehold | EPC Rating - B



We are delighted to offer this very well presented, modern family home situated in the ever-popular village of Watchfield. The property showcases a welcoming entrance hallway, leading to a comfortable lounge, a convenient downstairs cloakroom, a stylish kitchen/diner, and a practical utility room, all thoughtfully arranged on the ground floor.

Ascending to the first floor, you will find four generously sized bedrooms. The main bedroom is enhanced by en-suite facilities, and a family bathroom serves the remaining bedrooms.

Externally, the property boasts a very well maintained garden with a lush lawn and a charming patio area, perfect for relaxation and entertaining. A garage is conveniently located to the side of the property, with additional driveway parking.

Watchfield is a vibrant village, offering a range of amenities including a church, a school, local shops, pubs, and various sports facilities. The nearby village of Shrivenham provides even more conveniences. Both Oxford and Swindon are easily accessible via the A420, and the surrounding countryside presents ample opportunities for peaceful walks and exploration.

There is an estate service charge of £262.39 (2021).











# Floorplan

## Ground Floor

Approx. 70.5 sq. metres (759.0 sq. feet)

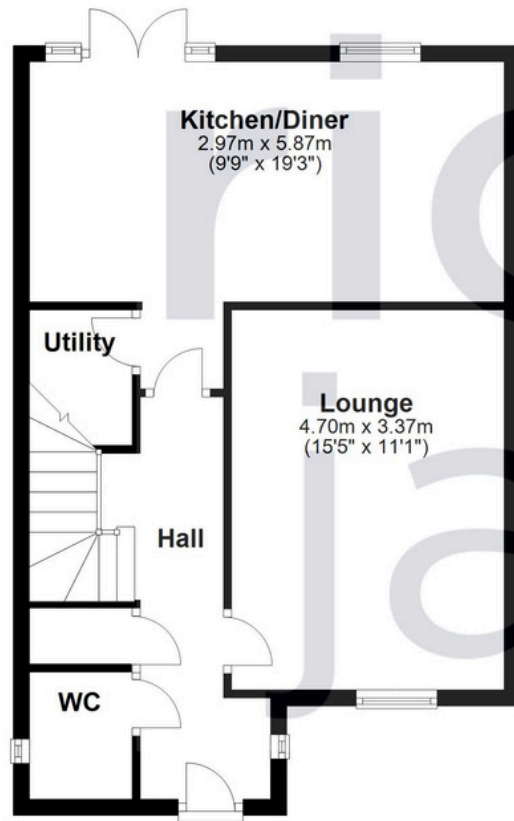

## First Floor

Approx. 50.1 sq. metres (539.4 sq. feet)

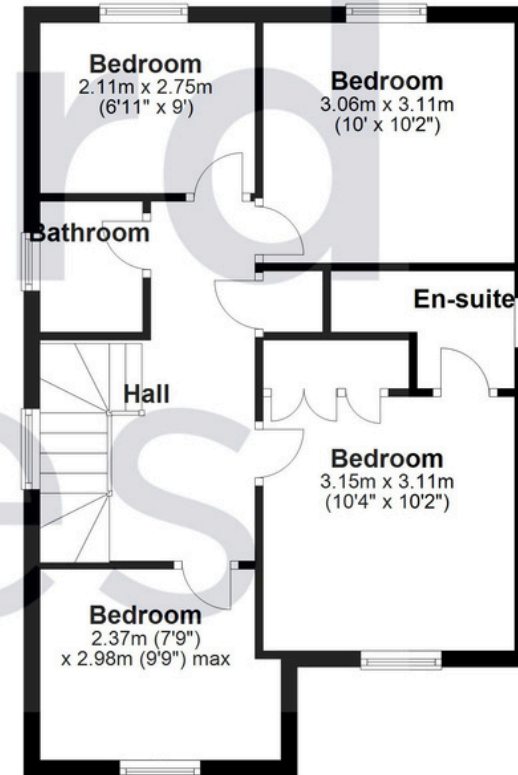

01793 765 292

highworth@richardjames.uk

36 High Street | Highworth | SN6 7AQ

richard james

richardjames.uk