



Norbury Court, Swindon, SN5 4BF

Offers Over **£120,000**

**richard  
james**



leasehold energy  
efficiency rating

C

Stunning village setting for over 55's only, first floor with a beautiful bay window giving views and a great feeling of space, easy access with lift and appliances included.

Entrance Hall, Bay Windowed Lounge/Diner, Fitted Kitchen , room. Bedroom with Built In Wardrobe. Communal Gardens, No Onward Chain.

Local Village Amenities and bus route on hand including Local Library. Swindon easily accessible by bus offering excellent Shopping and Leisure Facilities.

Viewing Highly Recommended and Strictly By Appointment with The Vendors Sole Agent Richard James.



## exceptional service

Our team will guide you through the process of buying or selling your home.

We have a team of dedicated sales progressors in place to ensure your purchase or sale runs smoothly through to completion, keeping you in the loop and a close eye on your chain while moving you in as swiftly and smoothly as possible.

- Honest valuations in current market conditions
- Dedicated sales progression team
- Recommended financial advisors
- 5\* service from valuation to completion
- Award winning lettings service
- Ahead of the game marketing strategies
- Professional photography
- Social media marketing
- Top listings on Rightmove and Zoopla

---

call us for a free  
valuation on your  
property

---

[rwb@richardjames.uk](mailto:rwb@richardjames.uk)

High Street | Royal Wootton Bassett | SN4 7AY

## Ground Floor

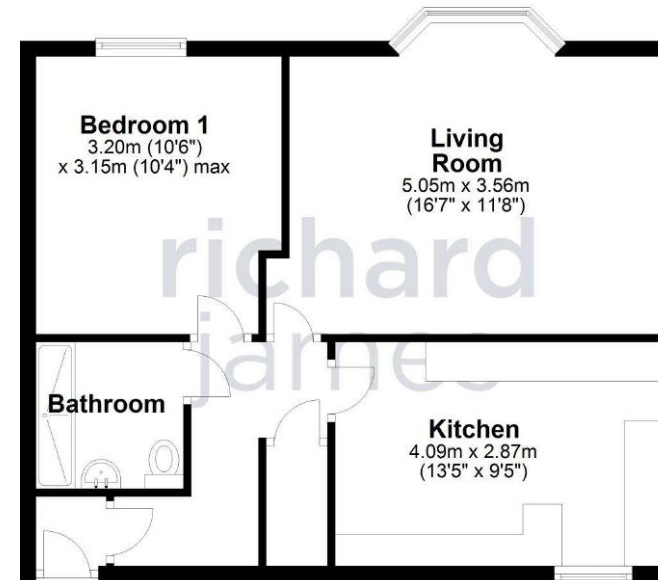

### Richard James & their clients give notice that:

1. These sales and particulars do not constitute any part of an offer of contract, and are for the guidance of prospective purchasers only and should not be relied on as statements of fact.
2. No representations are made in these particulars as to the condition of the property or as to whether any service or facilities are in good working order.
3. All Measurements are approximate.

rightmove 