



Barnsley Close, Tadpole Garden Village, SN25 2TU

Offers Over £350,000

richard james



Barnsley Close

Tadpole Garden Village

Freehold | EPC Rating - B



Offered for sale on the ever popular Tadpole development of North Swindon sits this well presented, three bedroom semi-detached family home.

On entry you'll find the hall with WC, great sized kitchen/diner and full width sitting room to the back of the property overlooking the rear garden.

Upstairs you'll find three bedrooms and the family bathroom. The master bedroom benefits from fitted wardrobes and an ensuite shower room.

The rear garden is a great size and offers ample outdoor space, with plenty of patio area and lawn. There are two parking spaces to the front of this home as well.





Both primary & secondary schools are within walking distance, along with the Tadpole Village Centre and all its amenities. Call us today to book your viewing.

EPC - B
COUNCIL TAX BAND - D





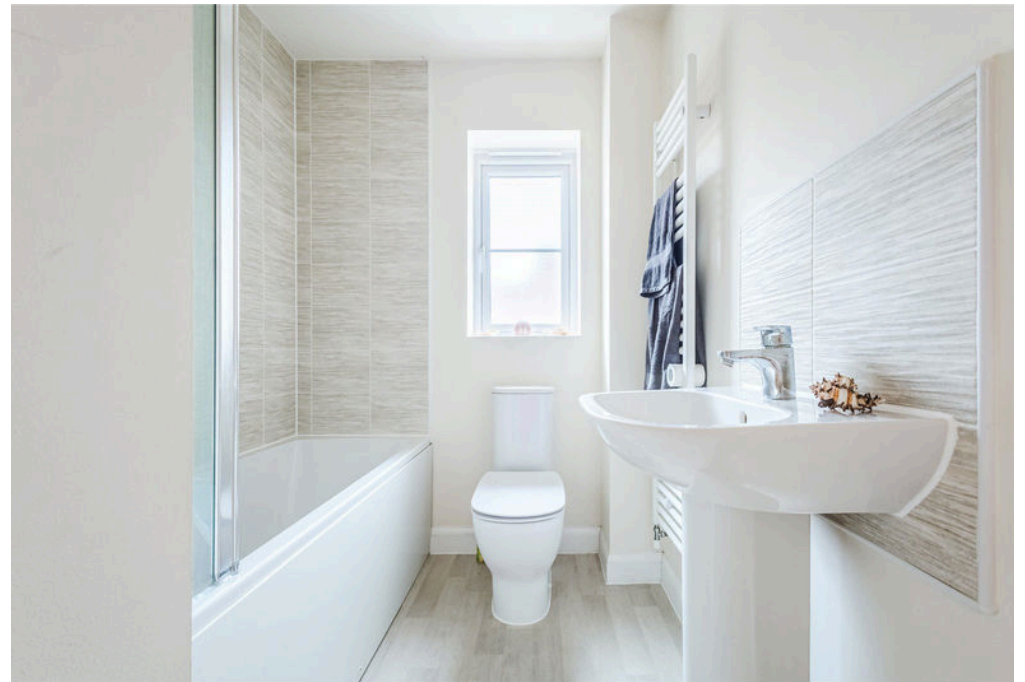



Floorplan

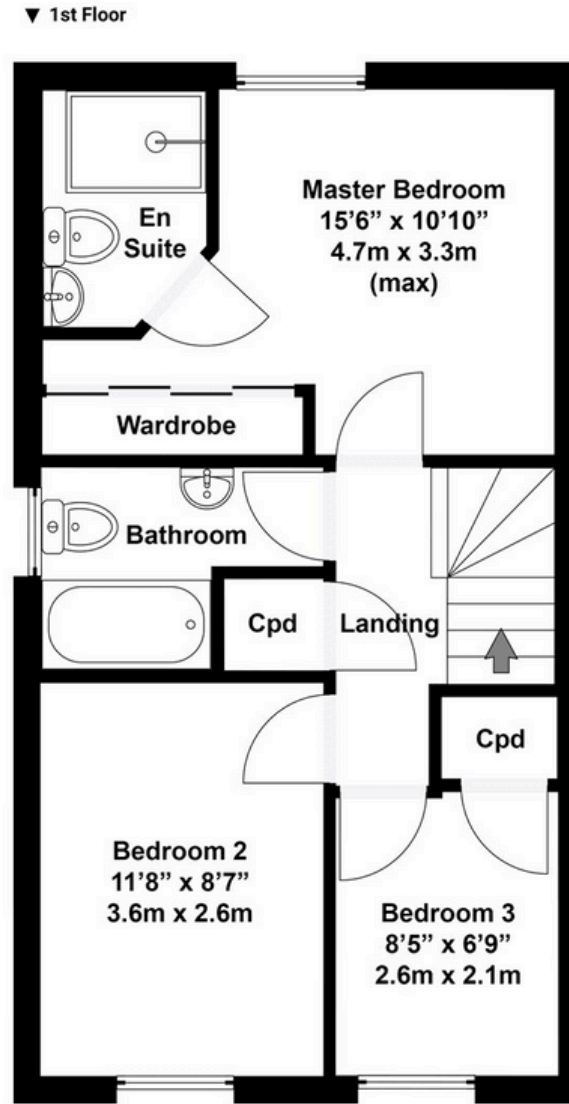
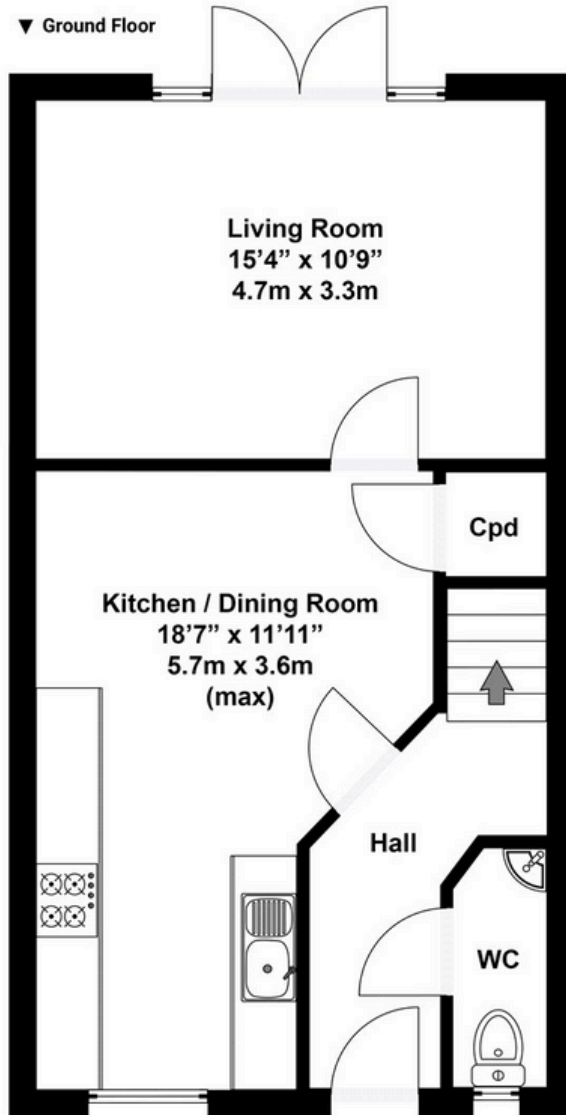

Total area approx: 860 sq ft / 80 sq m

N.B. Whilst care has been taken with this floor plan to reflect an accurate likeness of the property it should only be used as an approximation for illustrative purposes only, specifically no guarantee is given and all should not be relied on solely as a basis of valuation. Plan not to scale.

01793 261 262

northswindon@richardjames.uk

Gemini House | Hargreaves Road | Swindon | SN25 5AZ

richard james

richardjames.uk