



Riverdale Close, Old Town, SN1 4EE

asking price **£275,000**

**richard
james**



EPC RATING C

COUNCIL TAX RATING C

Offered for sale with NO ONWARD CHAIN and tucked away on this popular position at the bottom of Old town is this versatile three bedroom, semi-detached bungalow. The property offers an array of accommodation with the addition of a dormer on the first floor and comprises; entrance hall, living, kitchen, family bathroom and two bedrooms. On the first floor you'll find a good-sized bedroom with WC too. There is ample driveway parking to side, in front of the garage. The rear garden is a great size, laid mostly to lawn with ample patio space whilst offering a private place to enjoy the outdoors. The property sits only a five-minute drive from centra. Old town and all its amenities. Call us today to book your viewing.



exceptional service

Our team will guide you through the process of buying or selling your home.

We have a team of dedicated sales progressors in place to ensure your purchase or sale runs smoothly through to completion, keeping you in the loop and a close eye on your chain while moving you in as swiftly and smoothly as possible.

- Honest valuations in current market conditions
- Dedicated sales progression team
- Recommended financial advisors
- 5* service from valuation to completion
- Award winning lettings service
- Ahead of the game marketing strategies
- Professional photography
- Social media marketing
- Top listings on Rightmove and Zoopla

call us for a free
valuation on your property

oldtown@richardjames.uk

Victoria Road | Old Town | SN1 3BD

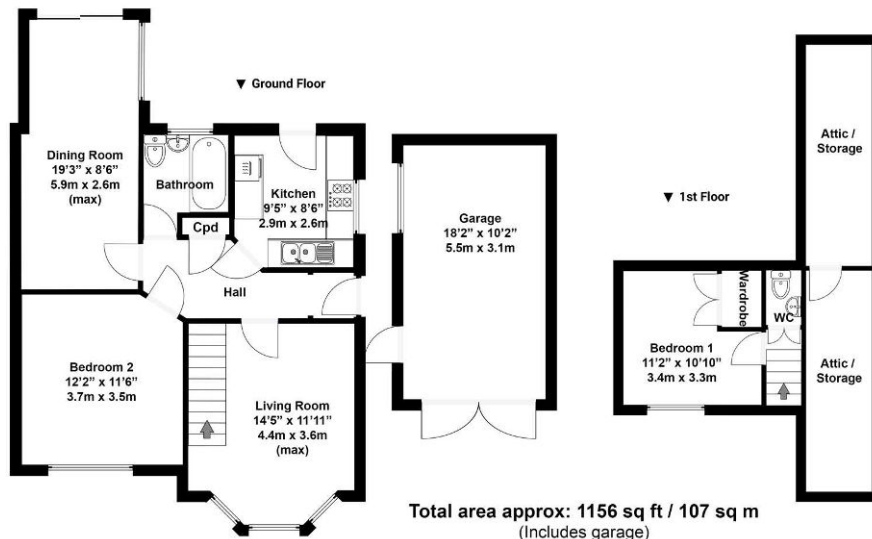

N.B. Whilst care has been taken with this floor plan to reflect an accurate likeness of the property it should only be used as an approximation for illustrative purposes only, specifically no guarantee is given and all should not be relied on solely as a basis of valuation. Plans not to scale.

Richard James & their clients give notice that:

1. These sales and particulars do not constitute any part of an offer of contract, and are for the guidance of prospective purchasers only and should not be relied on as statements of fact.
2. No representations are made in these particulars as to the condition of the property or as to whether any service or facilities are in good working order.
3. All Measurements are approximate.

rightmove 