



Station Road, Purton, SN5 4AJ

offers over **£400,000**

**richard  
james**





## freehold energy efficiency rating

Steeped in local history the 'Pike House' is a grade II listed PERIOD DETACHED family home which benefits from SASH WINDOWS, UNDER FLOOR HEATING, gas radiator central heating, sitting room, re fitted kitchen/dining room, family room, master bedroom with EN SUITE shower room, 2 further bedrooms, family bathroom, LANDSCAPED GARDENS, summer house/office, GARAGE/WORKSHOP and off road parking for numerous vehicles.

This property also has a Shepherds Hut with its own access offering an ideal chance for an Air B & B or a ideal office.

The property is well situated in the heart of the village and offers easy access to all local amenities shops, schools etc M4 J16 and A419.

VIEWING IS HIGHLY RECOMMENDED by the vendor's sole agent.







## exceptional service

Our team will guide you through the process of buying or selling your home.

We have a team of dedicated sales progressors in place to ensure your purchase or sale runs smoothly through to completion, keeping you in the loop and a close eye on your chain while moving you in as swiftly and smoothly as possible.

- Honest valuations in current market conditions
- Dedicated sales progression team
- Recommended financial advisors
- 5\* service from valuation to completion
- Award winning lettings service
- Ahead of the game marketing strategies
- Professional photography
- Social media marketing
- Top listings on Rightmove and Zoopla

---

call us for a free  
valuation on your  
property

---

[westswindon@richardjames.uk](mailto:westswindon@richardjames.uk)

Lucena House | Shaw Village Centre | SN5 5PY

Approximate Area = 1222 sq ft / 113.5 sq m

For identification only - Not to scale

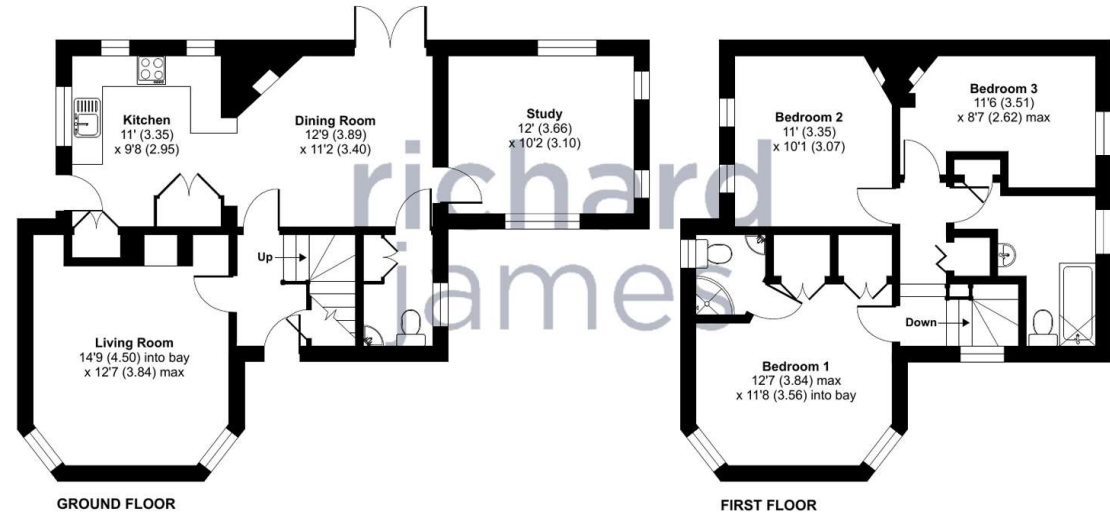

Floor plan produced in accordance with RICS Property Measurement Standards incorporating International Property Measurement Standards (IPMS2 Residential). © richcom 2024. Produced for Richard James. REF: 1094909.

### Richard James & their clients give notice that:

1. These sales and particulars do not constitute any part of an offer of contract, and are for the guidance of prospective purchasers only and should not be relied on as statements of fact.
2. No representations are made in these particulars as to the condition of the property or as to whether any service or facilities are in good working order.
3. All Measurements are approximate.

rightmove