



Wheatlands, Haydon Wick, SN25 1RL

**Offers Over £350,000**

**richard james**





## Wheatlands

### Haydon Wick

Freehold | EPC Rating - C



Offered for sale in the quiet Haydon Wick sits this larger than average five bedroom detached family home.

The property sits on a great plot and comprises; entrance hall, sitting room, dining room, WC and the kitchen. Upstairs offers five good sized bedrooms and the family bathroom.

The rear garden is a great size and offers a private space to enjoy the outdoors; with mature plantings, plenty of patio space and a lawn.

The property itself offers ideal access to all local amenities; you'll find both the A419 and North Swindon Orbital Centre within a short drive, whilst both primary & secondary schooling are within walking distance too.





Finished with a garage and off road parking - this is an ideal family home. Call us today to book your viewing.

EPC: C  
COUNCIL TAX BAND: D













# Floorplan

## ▼ Ground Floor

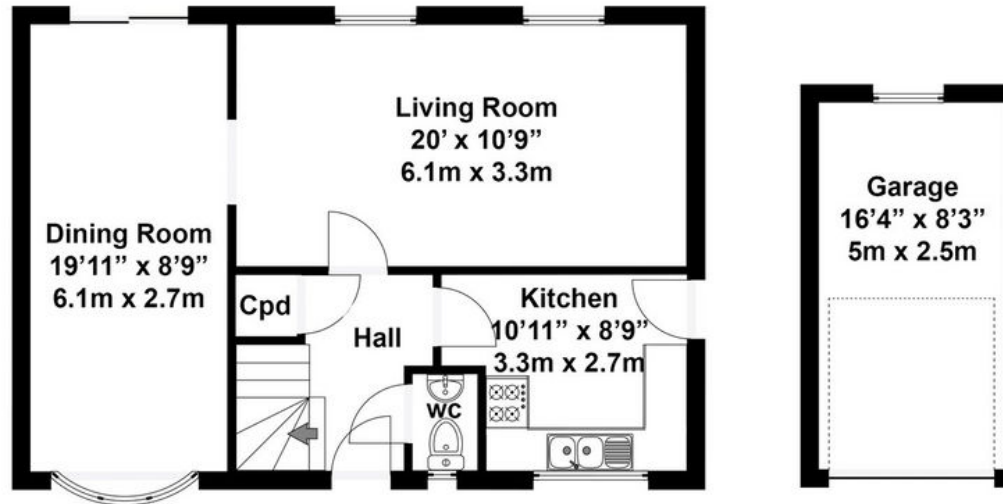

Total area approx: 1289 sq ft / 120 sq m  
(Includes garage)

## ▼ 1st Floor

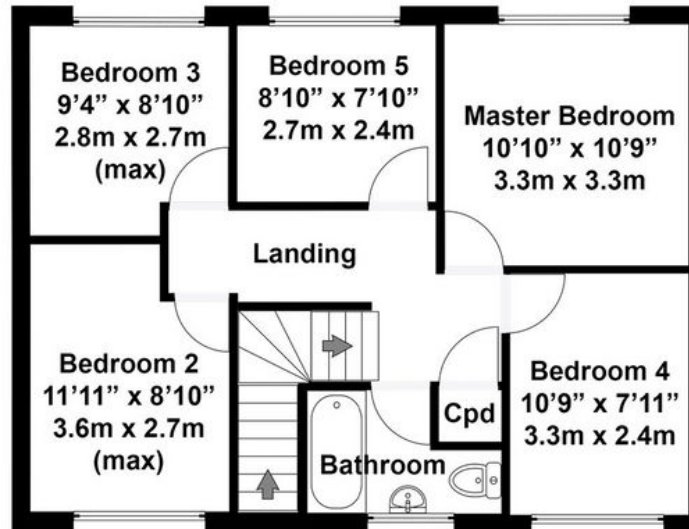

N.B. Whilst care has been taken with this floor plan to reflect an accurate likeness of the property it should only be used as an approximation for illustrative purposes only, specifically no guarantee is given and all should not be relied on solely as a basis of valuation. Plan not to scale.

01793 261 262

northswindon@richardjames.uk

Gemini House | Hargreaves Road | Swindon | SN25 5AZ

richard james

richardjames.uk