



Havisham Drive, Haydon End, SN25 1SL

**Offers Over £300,000**

**richard james**



## Havisham Drive

---

Haydon End

Freehold | EPC Rating - C

 4  2  2

Located in Haydon End, North Swindon, you'll find this generous and well-proportioned four double bedroom town house. Nearby to local schools and amenities such as the ever popular Orbital retail park, it's ideally placed.

On entry to the home there is a hallway allowing access to the lounge, downstairs WC and kitchen diner. The kitchen is a great size with plenty of space for a dining table and French doors to the rear garden.

On the first floor, there are two double bedrooms and the family bathroom. With a further two doubles, one of which with an en-suite occupying the top floor.



Externally, there is an enclosed rear garden as well as driveway parking and a garage.

Call now to arrange your viewing!

EPC: C  
COUNCIL TAX: D









# Floorplan

## ▼ Ground Floor

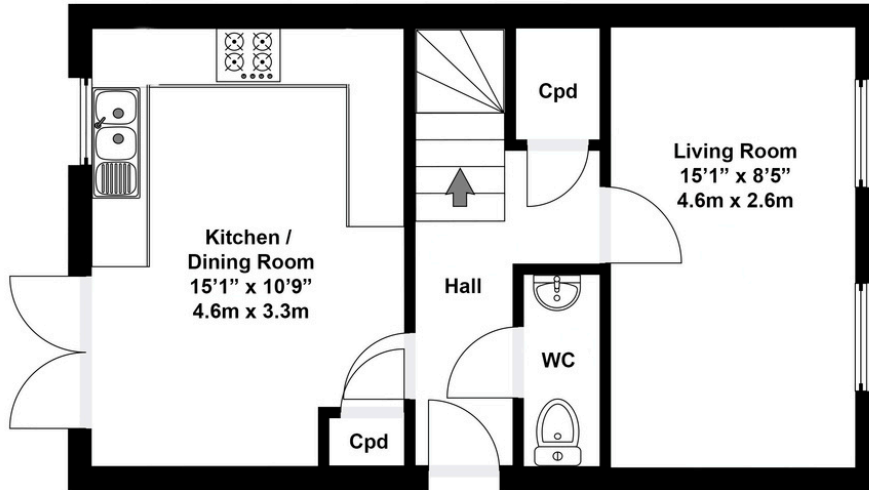

## ▼ 2nd Floor

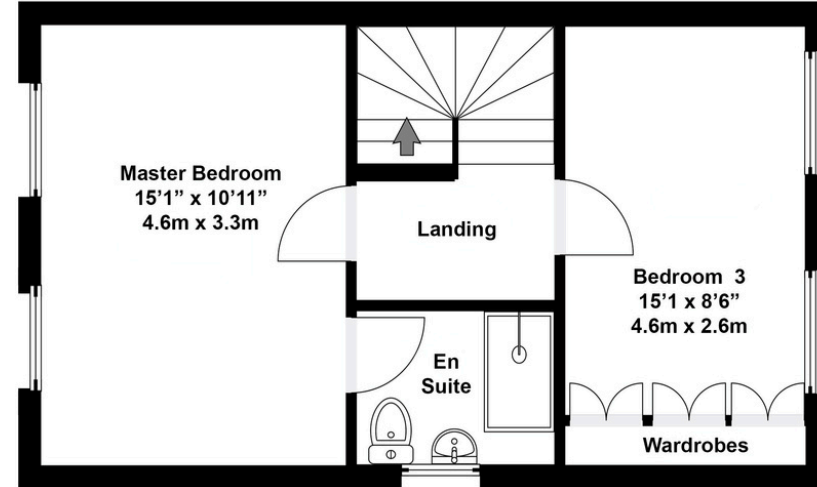

## ▼ 1st Floor

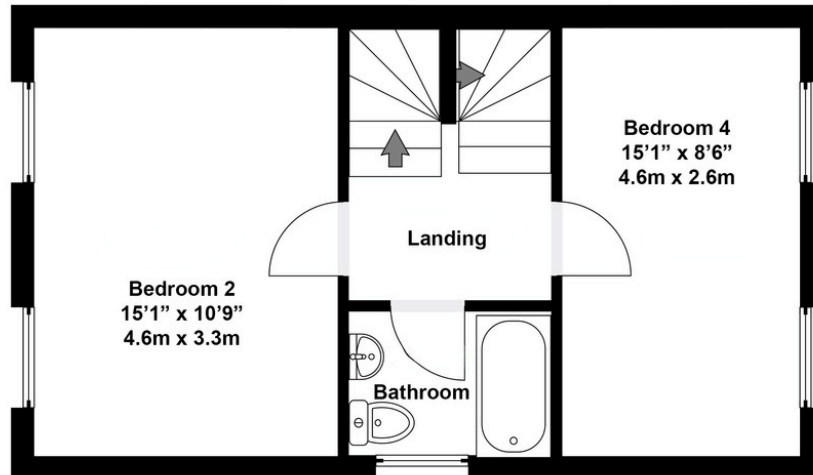

**Total area approx: 1309 sq ft / 122 sq m**  
(Includes adjacent garage)

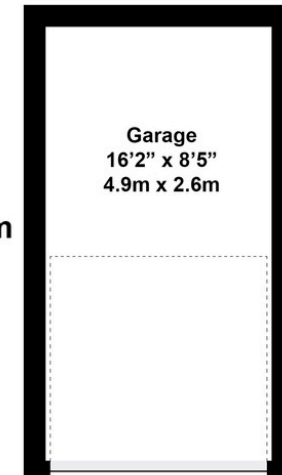

N.B. Whilst care has been taken with this floor plan to reflect an accurate likeness of the property it should only be used as an approximation for illustrative purposes only, specifically no guarantee is given and all should not be relied on solely as a basis of valuation. Plan not to scale.

**01793 261 262**

northswindon@richardjames.uk

Gemini House | Hargreaves Road | Swindon | SN25 5AZ

**richard james**

richardjames.uk