



Carter Close, Groundwell, SN25 4AD

Offers Over £280,000

richard james



Carter Close

Groundwell

Freehold | EPC Rating - C



Offered for sale in a quiet cul-de-sac in Groundwell, North Swindon sits this three bedroom townhouse. Benefiting from a modern kitchen and three double bedrooms it's ideal for families.

The accommodation is spread over three floors and comprises; WC, kitchen and a large sitting room/diner with patio doors onto the rear garden.

The first floor is occupied by two large double bedrooms and a family bathroom. On the top floor you'll find the master suite, complete with walk in wardrobe and an ensuite shower room - the ideal place to relax and unwind.

Externally, the garden offers privacy to the rear and is mostly laid to lawn with a patio area.



The home also comes with a single garage with driveway parking to the front.

Call now to arrange your viewing!

EPC: C
COUNCIL TAX: D









Floorplan

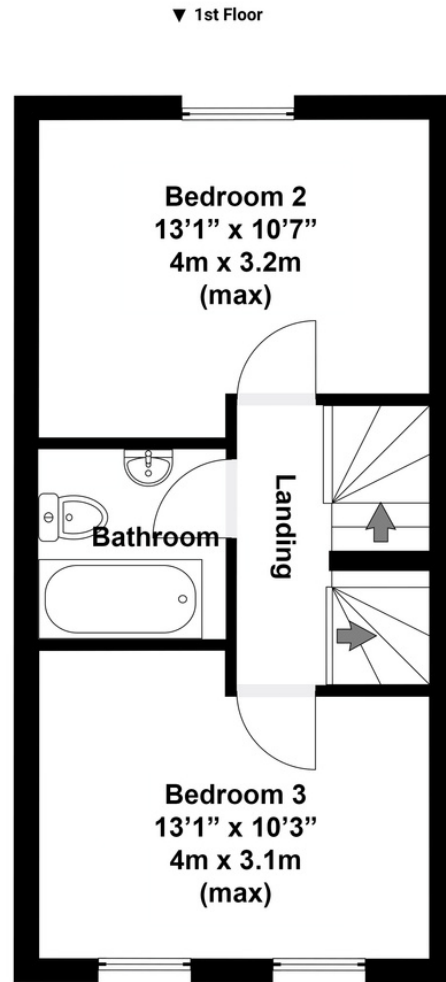
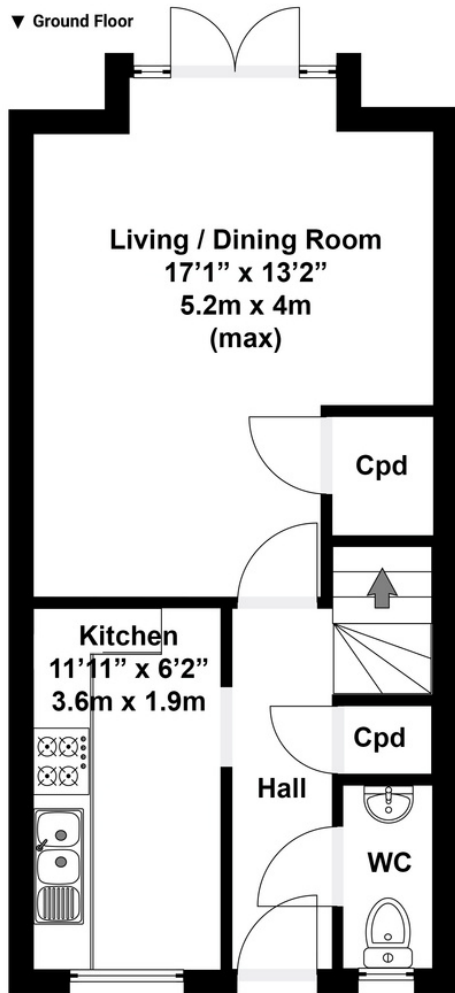

Total area approx: 1135 sq ft / 105 sq m
(Includes garage)

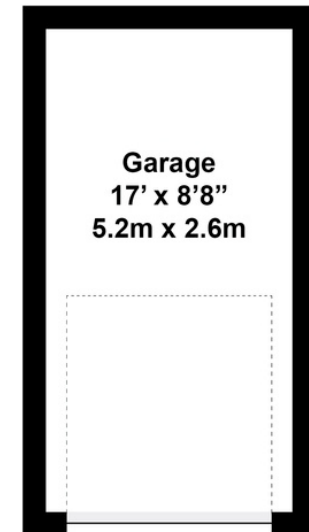
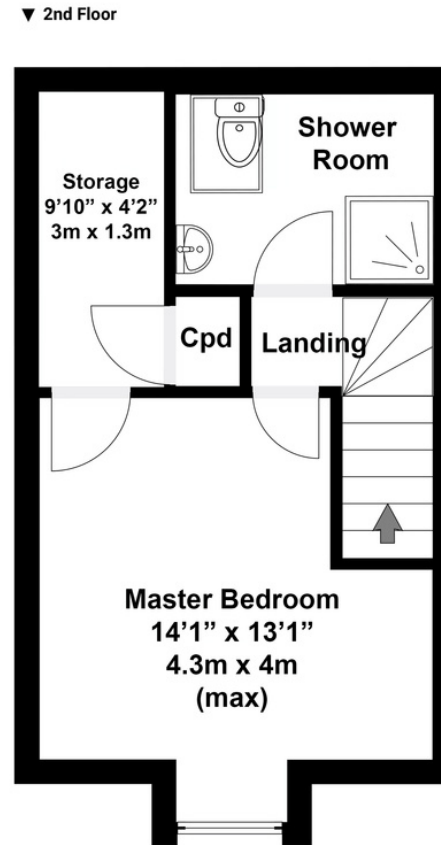

N.B. Whilst care has been taken with this floor plan to reflect an accurate likeness of the property it should only be used as an approximation for illustrative purposes only, specifically no guarantee is given and all should not be relied on solely as a basis of valuation. Plan not to scale.

01793 261 262

northswindon@richardjames.uk

Gemini House | Hargreaves Road | Swindon | SN25 5AZ

richard james

richardjames.uk