



Thursday Street, Haydon End, SN25 1TW

Offers Over £290,000

richard james



Thursday Street

Haydon End

Freehold | EPC Rating - TBC



This three bedroom end of terrace townhouse can be found perfectly situated between the local amenities of Taw Hill village centre, the local school and the ever-popular Orbital retail park.

The spacious accommodation over three floors comprises; entrance hall, WC, downstairs study and re-fitted kitchen diner to the ground floor.

On the first floor you'll find the bay fronted living room and master bedroom boasting an en-suite shower room.

At the very top, a further two double bedrooms with the family bathroom in the middle- a great layout for families, offering versatile living.





Externally the rear garden has been made low maintenance with a combination of patio and astro turf. There is also a single garage with parking space in front.

For an ideal family home, call now to arrange your viewing!

EPC - TBC
COUNCIL TAX BAND - D







Floorplan

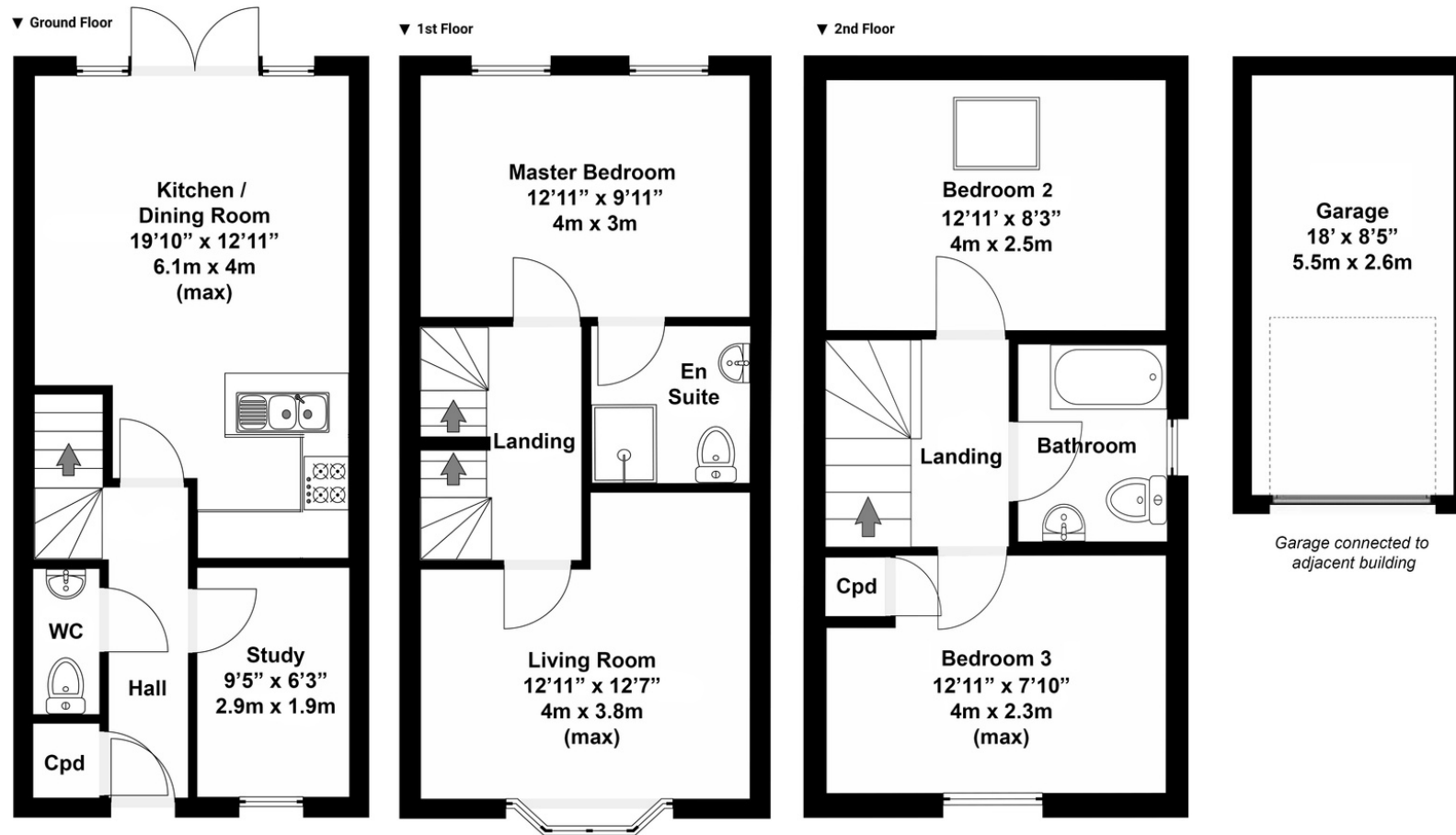

Total area approx: 1183 sq ft / 110 sq m
(Includes garage)

N.B. Whilst care has been taken with this floor plan to reflect an accurate likeness of the property it should only be used as an approximation for illustrative purposes only, specifically no guarantee is given and all should not be relied on solely as a basis of valuation. Plan not to scale.

01793 261 262

northswindon@richardjames.uk

Gemini House | Hargreaves Road | Swindon | SN25 5AZ

richard james

richardjames.uk