



Bayleaf Avenue, Woodhall Park

Offers IRO £280,000

richard james



Bayleaf Avenue

Woodhall Park

Freehold | EPC Rating - tbc



A generous three bedroom semi- detached home located in the ever popular location of Woodhall Park, North Swindon. Boasting three generous bedrooms, a garage with driveway parking, conservatory and outdoor bar, it makes for a lovely family home.

The home comprises; entrance hall, spacious lounge, dining room opening to the kitchen and a conservatory.

Upstairs, you'll find the family bathroom and three bedrooms all of which are of a good size, two doubles and a generous single.



Externally, the rear garden has been mostly laid to lawn with a new decked area beside the conservatory. A garden bar has also been added, making this a great entertaining space. A single garage along with driveway parking immediately to the side completes this great home.

Call now to arrange your viewing!







Floorplan

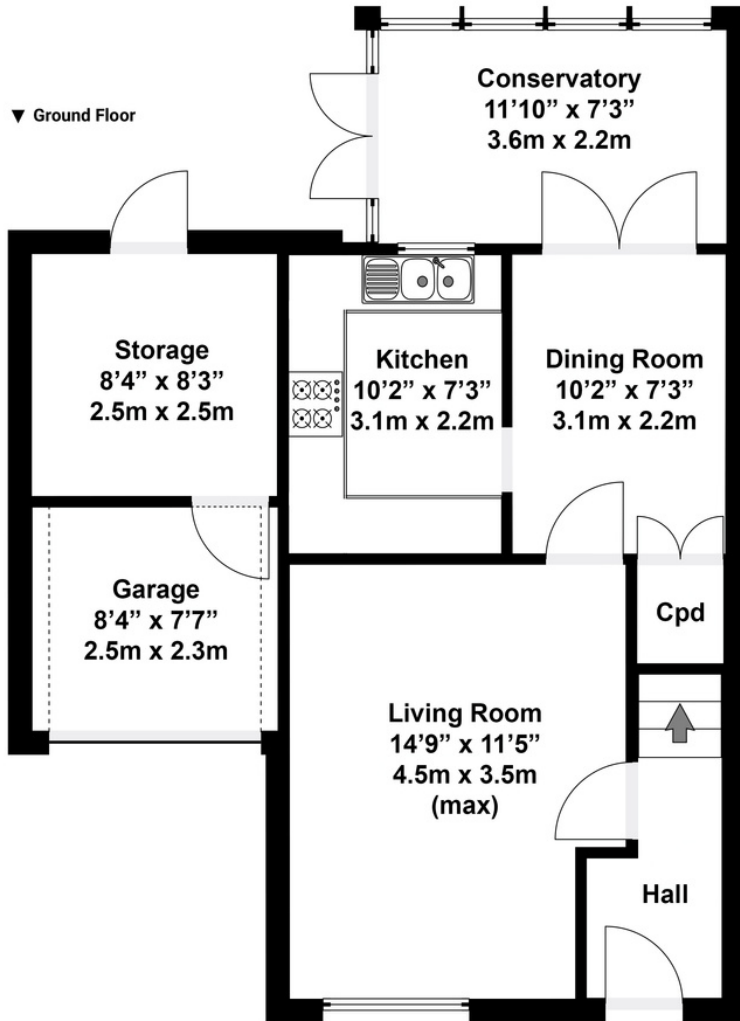

Total area approx: 935 sq ft / 87 sq m

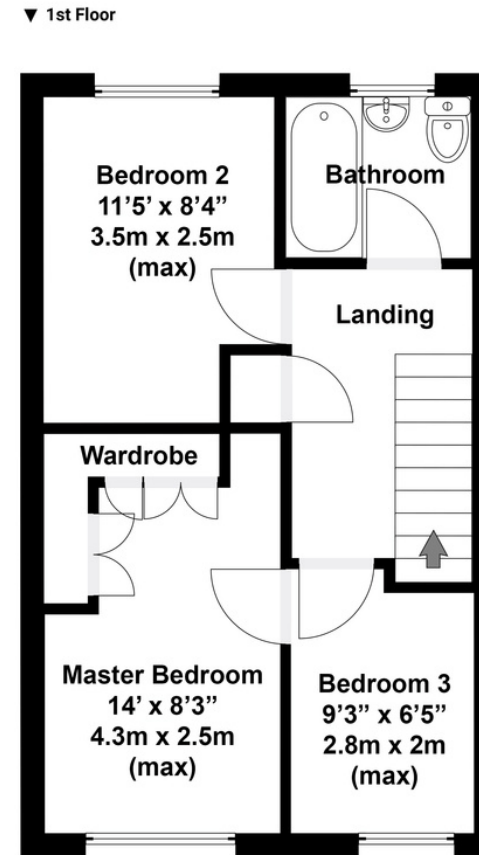

N.B. Whilst care has been taken with this floor plan to reflect an accurate likeness of the property it should only be used as an approximation for illustrative purposes only, specifically no guarantee is given and all should not be relied on solely as a basis of valuation. Plan not to scale.

01793 261 262

northswindon@richardjames.uk

Gemini House | Hargreaves Road | Swindon | SN25 5AZ

richard james

richardjames.uk