



Idstone Road, Ashbury, SN6 8LP

asking price **£275,000**

**richard
james**



3 1 1

freehold energy
efficiency rating

D

Richard James Village and Country Homes bring this semi-detached house to the market in the sought-after village of Ashbury, Wiltshire.

The property which requires refurbishment throughout would make an excellent first time buy or investment opportunity. The substantial rear garden would allow good home extension potential (Subject to usual planning permissions being obtained)

To the ground floor there is a small entrance hall with stairs to first floor, a sitting room, kitchen and bathroom. To the first floor there are two double bedrooms and a single/small double.

To the rear of the property is large, south facing garden which is mainly laid to grass with lovely views of the countryside, the frontage has a pathway to the front door with an open aspect/views over the countryside.

EPC - D

Council Tax Band - (Vale of White Horse)

Mains Drainage



exceptional service

Our team will guide you through the process of buying or selling your home.

We have a team of dedicated sales progressors in place to ensure your purchase or sale runs smoothly through to completion, keeping you in the loop and a close eye on your chain while moving you in as swiftly and smoothly as possible.

- Honest valuations in current market conditions
- Dedicated sales progression team
- Recommended financial advisors
- 5* service from valuation to completion
- Award winning lettings service
- Ahead of the game marketing strategies
- Professional photography
- Social media marketing
- Top listings on Rightmove and Zoopla

call us for a free
valuation on your
property

highworth@richardjames.uk

High Street | Highworth | SN6 7AQ

Ground Floor

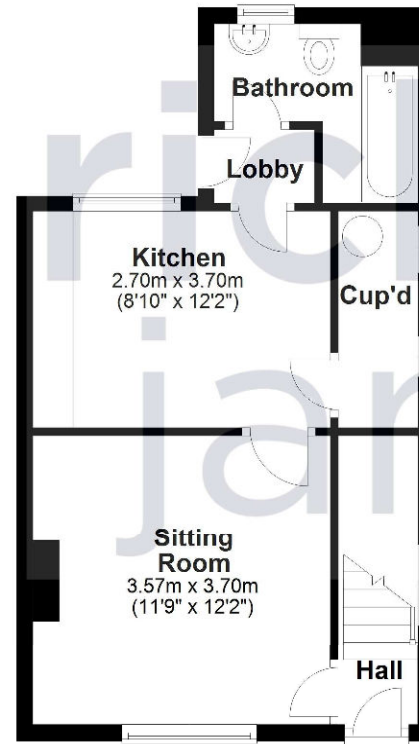

First Floor

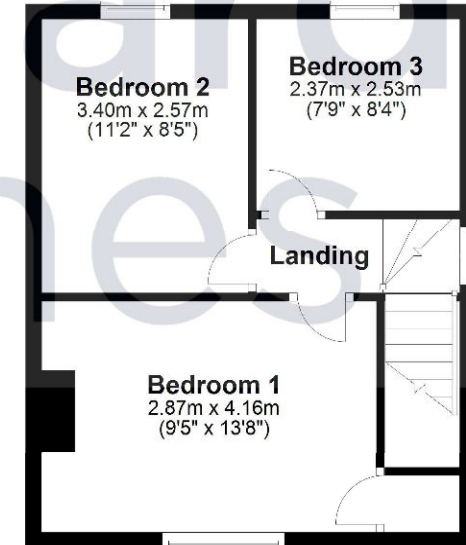

Richard James & their clients give notice that:

1. These sales and particulars do not constitute any part of an offer of contract, and are for the guidance of prospective purchasers only and should not be relied on as statements of fact.
2. No representations are made in these particulars as to the condition of the property or as to whether any service or facilities are in good working order.
3. All Measurements are approximate.

rightmove 