



Stoneywell, Tadpole Garden Village, SN25 2RR

Guide Price £460,750

richard james



Stoneywell

Tadpole Garden Village

Freehold | EPC Rating - B



Located in the sought after development of Tadpole Garden Village, North Swindon you'll find this substantial four bedroom detached home. Benefiting from ample living space and generous bedrooms, it's the ideal layout for a family.

Comprising; large entrance hall, downstairs study, 17' living room with bay window to front, WC, a full width kitchen/diner with box bay patio doors to rear and a separate utility.

The upstairs of this property is just as impressive, offering; four great bedrooms, an ensuite to the master bedroom and a four piece family bathroom.

Externally, the rear garden has been mostly laid to lawn with a patio area outside the french doors. A garage and driveway parking to the side complete this fantastic family home.



Tadpole is a great location, the home itself is within walking distance to popular primary and secondary schools, the local Sainsburys and the Strawberry Thief pub. Call us today to arrange your viewing!

EPC: B
COUNCIL TAX: F











Floorplan

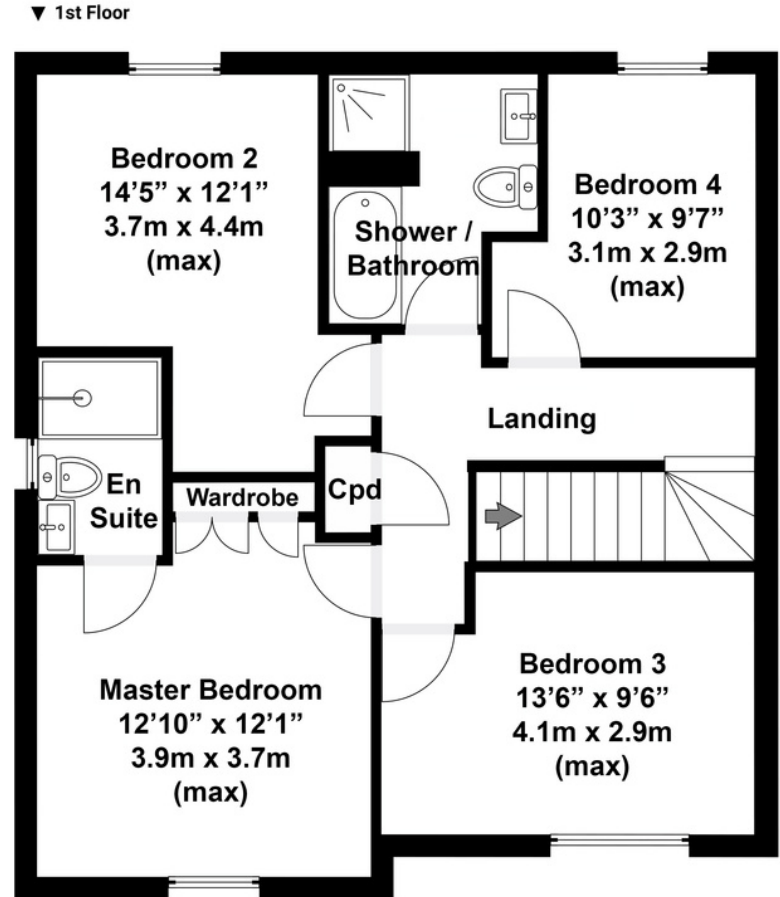
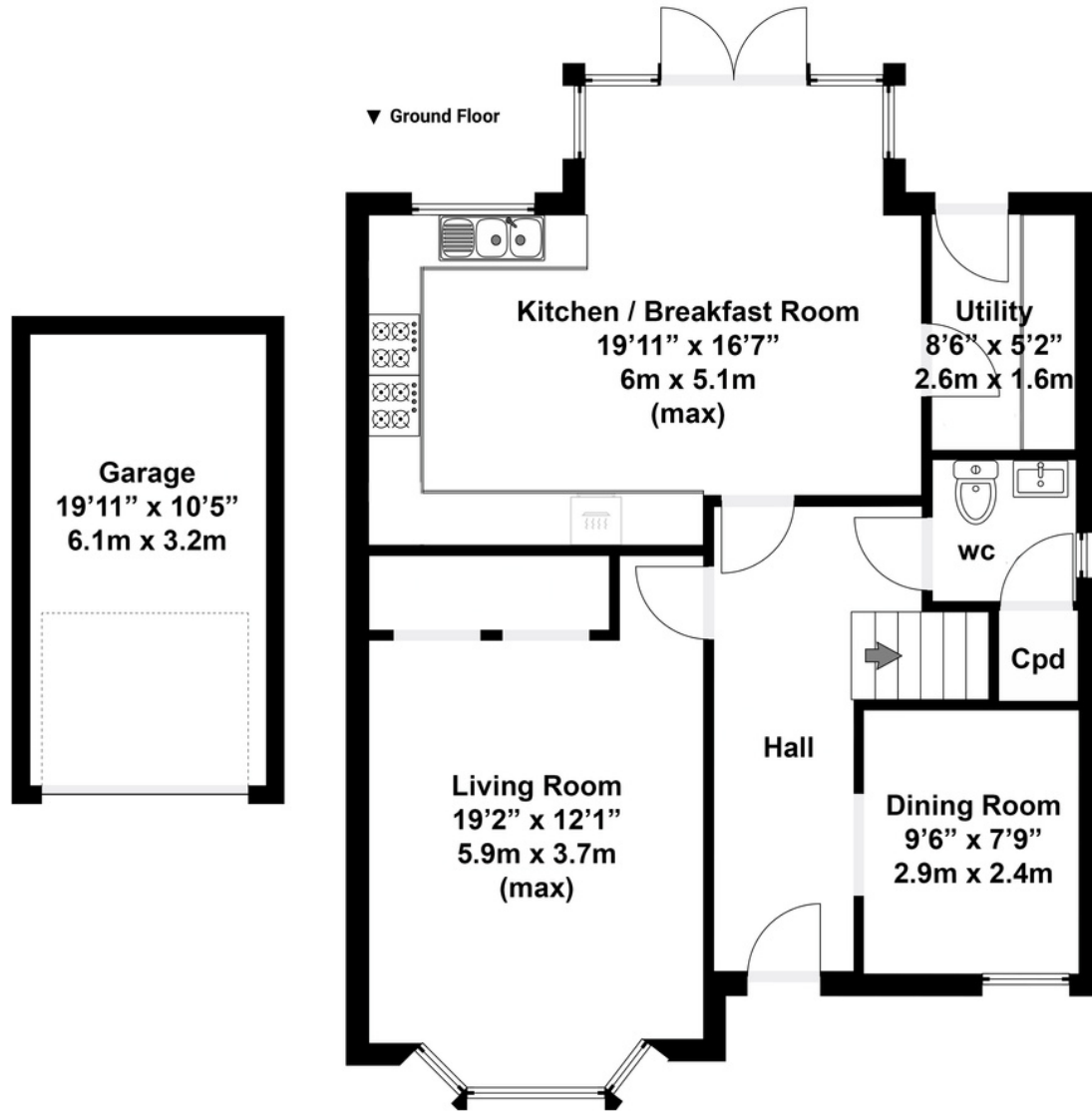

Total area approx: 1652 sq ft / 153 sq m
(Includes garage)

N.B. Whilst care has been taken with this floor plan to reflect an accurate likeness of the property it should only be used as an approximation for illustrative purposes only, specifically no guarantee is given and all should not be relied on solely as a basis of valuation. Plan not to scale.

01793 261 262

northswindon@richardjames.uk

Gemini House | Hargreaves Road | Swindon | SN25 5AZ

richard james

richardjames.uk